

# FO-DC535/FO-DC635

## document **communication** system

# SHARP®

## advanced functionality in a compact desktop design

The new Sharp FO-DC535/DC635 Advanced Document Communication Systems are designed to grow with your business, so you can easily add feature sets as your business needs change. With modular solutions that deliver network scanning, network printing, web-based management, and advanced diagnostics, Sharp makes it easy to leverage your investment with added value.



### PC Lan Faxing

With Sharp's **convenient LAN Fax function**, you can transmit documents right from your desktop PC! With easy-to-use software, sending a fax is just as easy as 1-2-3. (Requires FO-LN1)

### Convenient, Built-in Network Scanning

With its flexible suite of document management tools, the Sharp FO-DC Series network scanning option provides seven scanning functions that can streamline your workflow—**Send to Desktop**, **Send to E-mail**, **Send to FTP**, **and Send to Group (e-mail/fax mixed)**, **Send to Internet Fax**, **Send to USB**, and **Send to Folder**. And with Sharpdesk™ document management software, you get a complete suite of tools to view, edit, distribute, and integrate faxed documents into your workflow for added efficiency. (Requires FO-LN1 and FO-NS2)

### Enhanced Inbound Routing

The Sharp FO-DC Series **Inbound Routing** feature automatically forwards inbound faxes to e-mail addresses for seamless distribution. You can even customize this feature to route faxes at specific dates and times. (Requires FO-NS2)

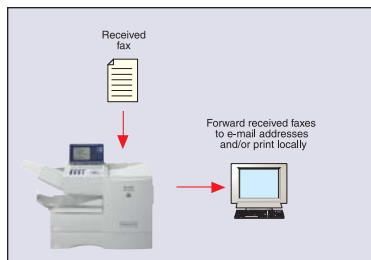

### Advanced Internet-based Control

The FO-DC Series Home Page offers many time saving tools, such as **scan and fax destination management**, **E-mail status notifications**, **remote diagnostics**, **device configuration**, and more. (Requires FO-LN1)

### Efficient Network Printing

With the optional PCL6/PCXL Network Printing Expansion Kit, you can transform the FO-DC Series facsimiles into powerful 16-ppm network laser printers with **crisp 600-dpi resolution**. (Requires FO-LN1 and FO-NP1)

### Advanced Document Administration

With Sharp's **Advanced Document Administration** function, blind copies of all inbound and outbound faxes, PC faxes, and Send to E-mail documents are sent to an administrator's e-mail address or FTP site. This convenient feature tracks and maintains electronic records of all communications.

### Printer Administration Utility (PAU)

Designed to **speed up the installation and configuration of all connected Sharp devices**, PAU enables administrators to manage all SNMP-compliant printers on the network from a single interface. (Standard with FO-NP1)

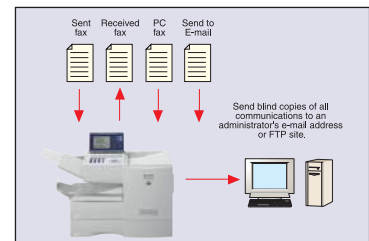

### Printer Status Monitor

With the ability to **view network printer conditions right from your desktop**, Printer Status Monitor enables you to check paper levels, toner, and more—before you print your job. It even notifies you when your job is complete! (Standard with FO-NP1)

### Remote E-Mail Diagnostics

Sharp's Remote E-mail Diagnostics (R.E.D.) enables users, administrators, or your Sharp service providers to **automatically receive e-mail messages** regarding specific conditions of the FO-DC Series. From basic maintenance to more complex needs, R.E.D. helps ensure that your FO-DC Series performs optimally. (Standard with FO-LN1)

### LAN-Based F.A.S.T. System Remote Management

With Sharp's LAN-Based F.A.S.T. (Facsimile Automated Service Technology) Remote Diagnostics System, the FO-DC Series **monitors vital statistics**, such as fax operation, printing, paper handling, and supply usage. This enables your authorized Sharp dealer to monitor and diagnose potential issues right over the Internet—minimizing costly downtime. (Requires FO-LN1)

# FO-DC535/FO-DC635

## advanced **workflow** systems

### Key Features

### FO-DC535

### FO-DC635

Scan/Print Counter:	Yes	Yes
Menu Mode Lock Feature:	Yes	Yes
Duplex Scanning Function:	Yes	Yes
One-Touch (Rapid) Dials:	59	59
Abbreviated (Speed) Dials:	100	200
Personal Auto-Dial Books:	20	40
Document Administration:	Optional <sup>1, 2</sup>	Optional <sup>1, 2</sup>
Group Dialing:	158 Locations	258 Locations
Polling:	179 Locations	279 Locations
Serial Broadcasting:	179 Locations	279 Locations
Program Keys:	59	59
Confidential Send/Receive:	10 Boxes	10 Boxes
Memory:	8 MB Standard	16 MB Standard
AntiJunk Fax:	50 Locations	50 Locations
Department Codes:	99	99
Telephone-Billing Codes:	9 Digits	9 Digits
Secure Fax Release:	Yes	Yes
Batch Transmission:	59 Jobs	59 Jobs
Secure Phone Line:	Yes	Yes
Quick On-Line:	Yes	Yes
Automatic Cover Sheet:	Standard	Standard
Flash ROM Updates:	Yes	Yes
Cassette Switching:	Standard	Standard
Fax Separator Page:	Standard	Standard
PC LAN Fxing:	Optional <sup>1</sup>	Optional <sup>1</sup>
Inbound Fax Routing:	Optional <sup>1, 2</sup>	Optional <sup>1, 2</sup>
Dual Line Kit:	—	Optional

### Optional Expansion Kits and Specifications

#### LAN Interface Expansion Kit FO-LN1 (optional)

Operating System:	Windows® 98 2nd edition/ME/2000/NT4/XP and Win 2003 Servers (for FO-NP1 only)
Protocol:	TCP/IP
Type:	10/100 baseT
Requirements:	Ethernet LAN, Mail Server, FTP Server
Utilities/Software:	IP Peer to Peer Web page for configuration and maintenance

#### Network Printing Expansion Kit FO-NP1 (optional)<sup>3</sup>

Print Speed:	16 pages per minute
Print Resolution:	600 dpi
Printer Description Language:	PCL6/PCL XL
Fonts:	45 outline fonts
Memory:	16 MB/128 MB maximum
Utilities/Software:	Integrated installer, print drivers, Printer Status Monitor, and Printer Administration Utility

#### Network Scanner Expansion Kit FO-NS2 (optional)

Scan Resolution:	200 dpi (true optical)
Data Format:	PDF, TIFF
Protocol:	FTP, SMTP
Document Mgt. Software:	Sharpdesk™
OCR:	Included with Sharpdesk software
Scan to E-mail:	Standard
Scan to Desktop:	Standard
Scan to FTP:	Standard
Utilities/Software:	Sharpdesk, Network Scan Tool

<sup>1</sup> Requires FO-LN1 LAN Interface Expansion Kit

<sup>2</sup> Requires FO-NS2 Network Scanning Kit

<sup>3</sup> On FO-DC635, the FO-60DL Dual Line Kit cannot be installed in conjunction with FO-NP1 Network Printing Expansion Kit.



As an ENERGY STAR® Partner, Sharp has determined that this product meets the ENERGY STAR® guidelines for energy efficiency.

# SHARP®

SHARP ELECTRONICS CORPORATION  
 Sharp Plaza  
 Mahwah, NJ 07430-2135  
 1-800-BE-SHARP  
[www.sharppusa.com](http://www.sharppusa.com)

Design and specifications subject to change without notice. Sharp is a registered trademark of Sharp Corporation. All other trademarks and registered trademarks are property of their respective holders.